

**Technical Specifications:**

Input Voltage: 200-240VAC 50/60Hz

Power: 12W

Beam Angle: 60 degree

IP Rating: IP44

PF: &gt;0.9

Cut Out: 90mm

3000K, 4000K, 6000K Tri Colour Setting

Lumens: 1050, 1200, 1100

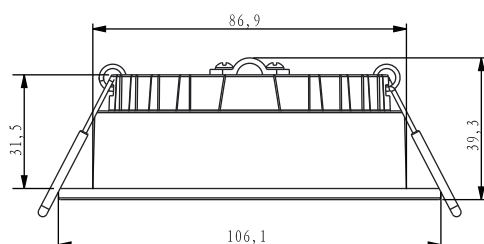
**Warn:**

1, Before installation or maintenance ensure that the mains supply to the luminaire is switched off and the circuit supply fuses are removed or circuit breaker turned off.

2, A qualified electrician **MUST** be consulted or used for the installation of this luminaire.

3, The luminaire must be installed to the relevant building regulations.

4, Check that the total load on the circuit, including when this luminaire is fitted, does not exceed the rating of the circuit cable fuse or circuit breaker.

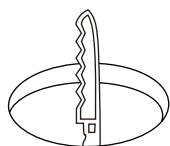
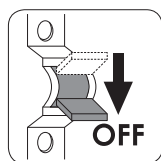
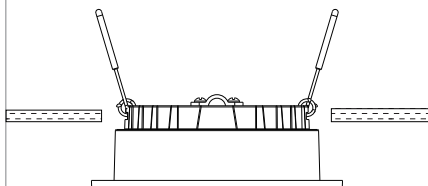
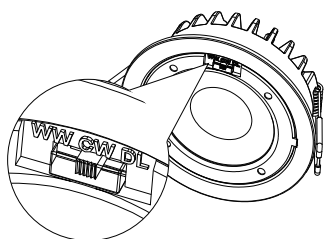
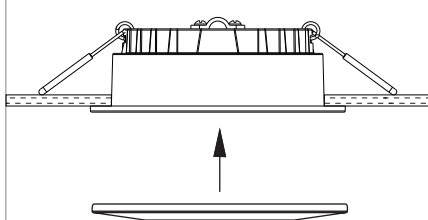
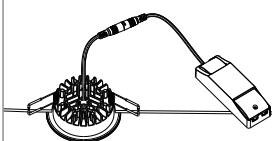
**a.** Switch off power**b.** Prepare cut-out hole in your surface to specified dimensions as stated in above drawing.**e.** Place driver into recess then push back spring clips and insert luminaire into recess.**c.** Select desired colour output via front mounted switch -WW-3000K, CW-4000K, DL-6000K**f.** Place one of the supplied magnetic bezel to complete installation.**d.** Connect the mains power cable to the driver**g.** Switch power on at circuit

**NB.** For high voltage circuit insulation testing disconnect mains input supply first



(Do not circuit test using a megger)

**Changing Colour Temperature**

To change colour temperature after installation

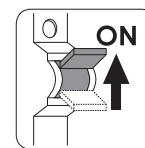
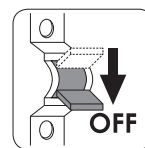
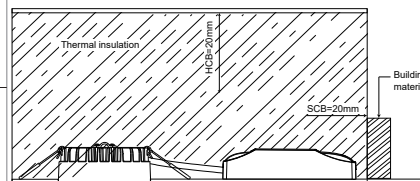
**i.** Ensure power is switched off.**ii.** Remove magnetic bezel and switch to desired colour temperature.**iii.** Replace bezel**iv.** Switch power on at circuit**Installation Spacing**

**RISK OF FIRE** -Required clearance from structural members and building elements

SCB=20mm

HCB=20mm